

## 05-3 Push Locks

05

Locks

### 68510 Push Latch With Knob

- \* Material: plastic base with zinc alloy or plastic handle
- \* Finish: gold, nickel, black nickel, matt nickel or matt gold
- \* Accessory: 1 pc of plastic strike plate
- \* Ø25mm drilling hole
- \* For door of 18 ~ 24mm thickness
- \* **6851-P03** 3mm spacer is required for 15 ~ 17mm thick door

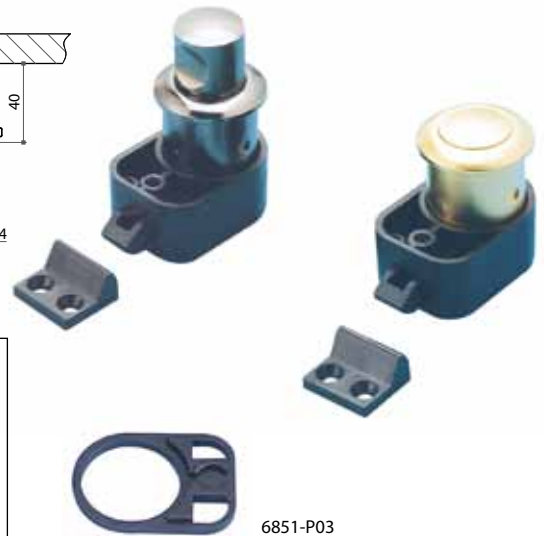
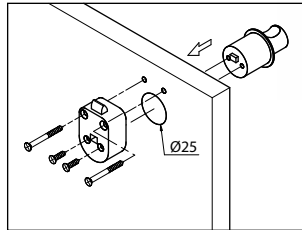
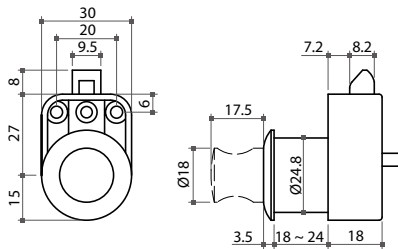

### 68470 Push Latch With Handle

- \* Material: zinc alloy latch, soft plastic handle
- \* Finish: gold, nickel, black nickel, matt nickel or matt gold
- \* For door of 12 ~ 15mm thickness
- \* Accessory: 1 pc of plastic strike plate
- \* Close the cabinet door/drawer and it will be locked automatically
- \* Hold the soft plastic handle and push the central button to open the cabinet door/drawer

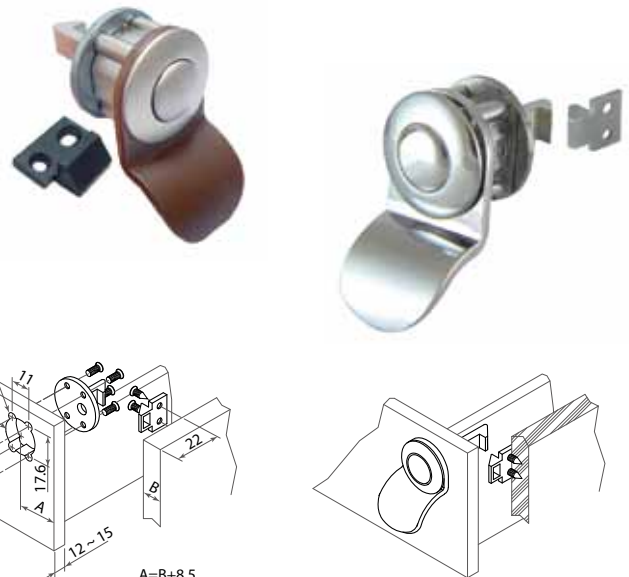
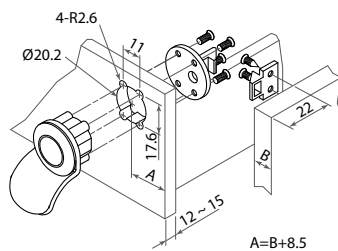
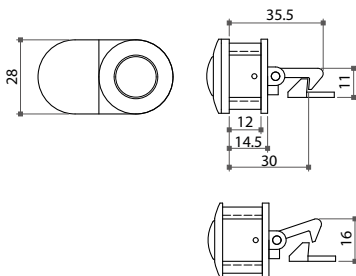

### 68480 Push Lock With Key

- \* Material: zinc alloy
- \* Finish: gold, nickel, black nickel, matt nickel or matt gold
- \* With 2 keys

