

## 07-4 Shelf Supports & Fittings

### 58494 Glass Shelf Support

- \* Material: zamak
- \* Pin size: Ø5x9mm
- \* With glass sucker
- \* Finish: nickel or brass plated

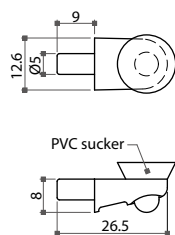

Item No.	Size
58494	12.6x26.5mm

### 58252 Safety Shelf Support

- \* Clear transparent plastic housing with steel pin
- \* For Ø5mm drillhole
- \* Only for 5mm glass thickness

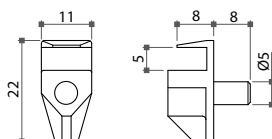

Item No.	Size
58252	Ø5x17mm L.

### 20367 Glass Shelf Support

- \* Material: steel
- \* Pin size: Ø5x9mm
- \* Inner size: 8.2mm
- \* For glass of 5 ~ 6mm thickness
- \* Finish: black, brass or nickel plated

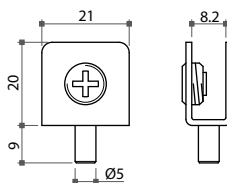
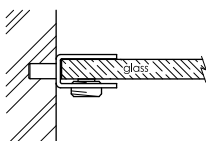

Item No.	Inner size	Glass thickness
20367	8.2mm	5 ~ 6mm

### 20375 Glass Shelf Support

- \* Material: steel
- \* For glass of 5 ~ 6mm thickness
- \* With counter screw hole (Ø5.7mm)
- \* Finish: nickel plated

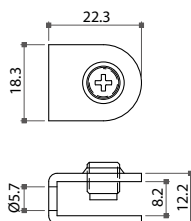

Item No.	Inner size	Glass thickness
20375	8.2mm	5 ~ 6mm