

03-4 Interior Sliding Door

56940 Interior Top Hung Sliding Door Fittings

- * Precision ball-bearing conducts silent movement
- * Recessed mounting on wooden door
- * Effectively minimize the gap between the suspension fittings & the door
- * Loading capacity: 50 kgs per door



03

Sliding & Folding Door

56940T Inner Running Gear

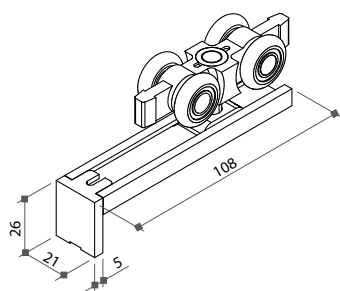

56940B Bottom Buffer

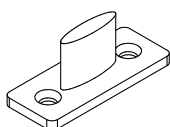

56940S Stopper

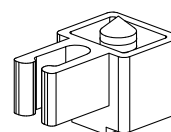

Track-C28B Aluminium Track

- * Medium duty type

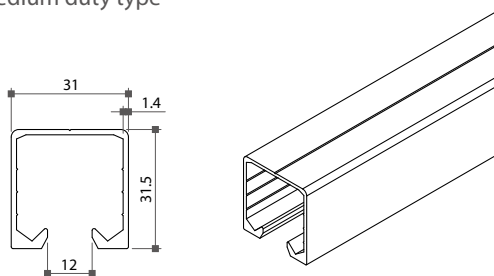

Track-C28A Aluminium Track

- * Heavy duty type

