

07-3 Glass Shelf Supports & Fittings

Concealed Wall Shelf Holder

- * Concealed shelf holder of zinc plated steel, including screws and wall plugs for wall fixing, Ø8mm drillhole
- * 3 independent adjustments: vertical, horizontal & inclination
- * Maximum distance between two shelf holders: 700mm
- * 3 holders are suggested for mounting distance beyond 900mm
- * For chipboard shelf of 25mm thickness minimum or honeycomb shelf of 50mm thickness minimum
- * For a stronger fixing, use an excenter with Ø15mm cam and dowel with M6 thread



58940 Concealed Shelf Holder

- * For shelves of 25mm thickness minimum and 300mm depth
- * Adjustments: vertical $\pm 3\text{mm}$, horizontal $\pm 4\text{mm}$, inclination $\pm 2^\circ$

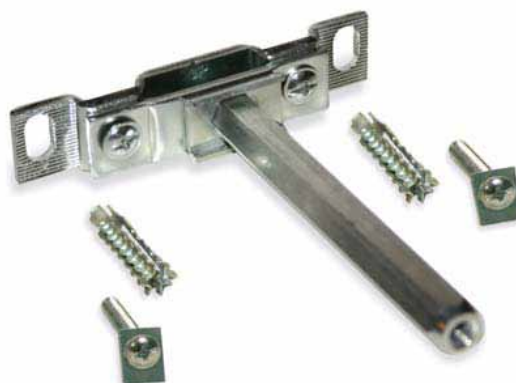
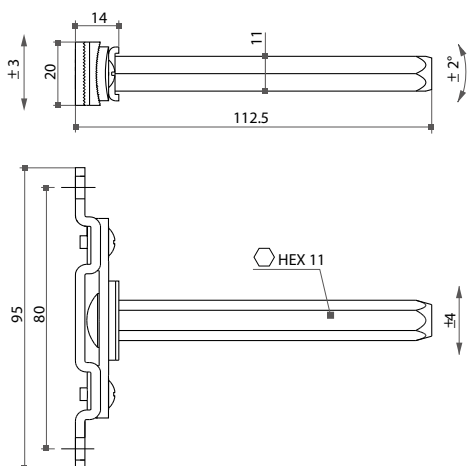

Machining assembling: Direct

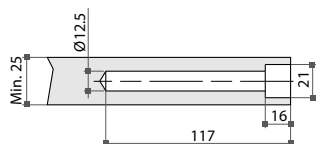

With excenter Ø15mm

