

# 16-3 Keyboard Trays

## 89930 Keyboard Arm and Tray

- \* With keyboard tray and mouse pad
- \* Easy height adjustment of 146mm by finger, and  $\pm 15^\circ$  tilt by handle lever
- \* Rotation 360°
- \* To be mounted under worktable (desk top), meets ANSI/BIFMA x 5.5 standard

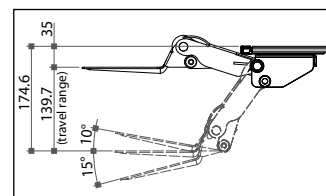
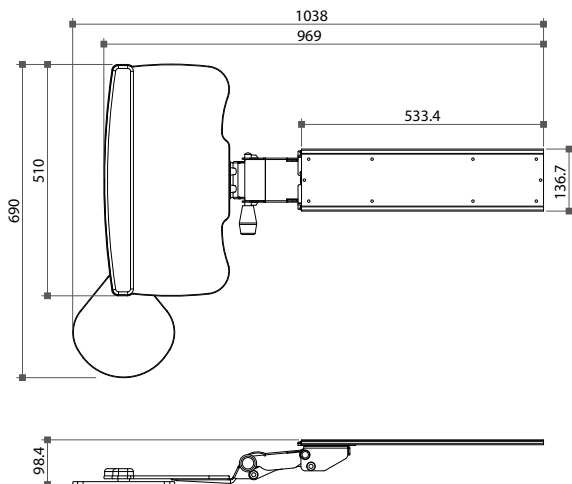

## 89401 Notebook Drawer

- \* To be mounted under desk top
- \* With full extension ball bearing slide and a cam lock to secure notebook

