

03-4 Interior Sliding Door

56950 Interior Top Hung Sliding Door Fittings

- * Precision ball-bearing conducts silent movement
- * Recessed mounting on wooden door
- * Effectively minimize the gap between the suspension fittings & the door
- * Loading capacity: 50 kgs per door

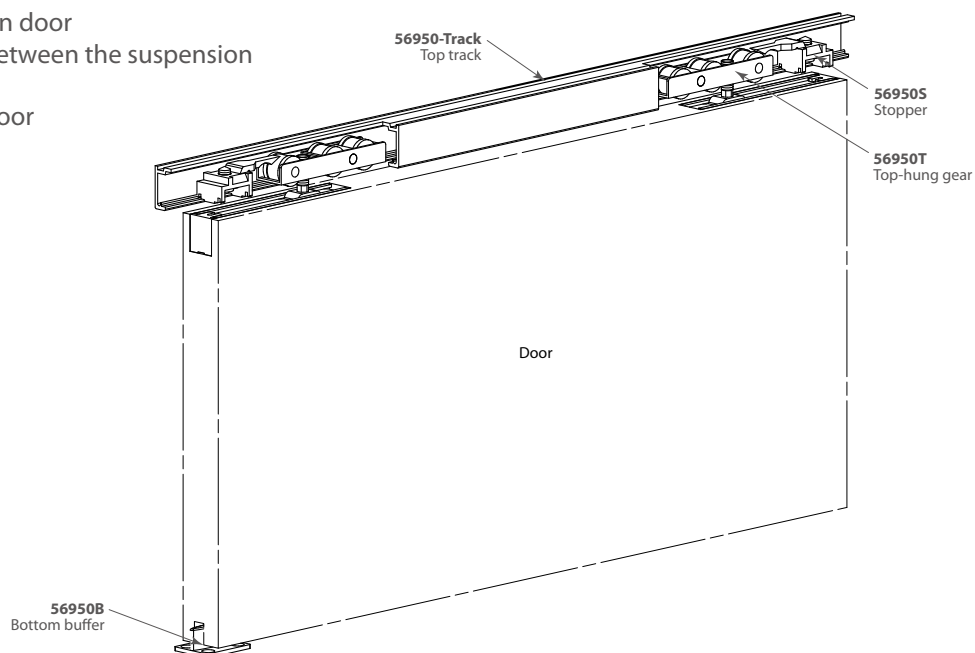

56950T Top Hung Gear

- * Zamak
- * Auto-adjust the door position to fit the slightly deformed door frame due to humidity or height difference

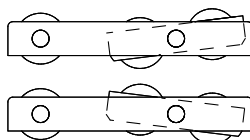
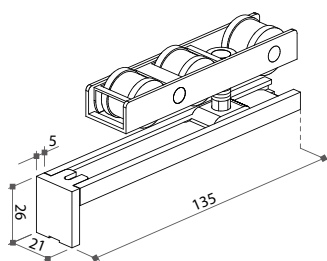

56950S Stopper

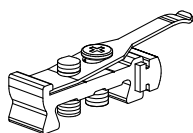

56950B Bottom Buffer

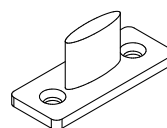

56950-Track Aluminium Track

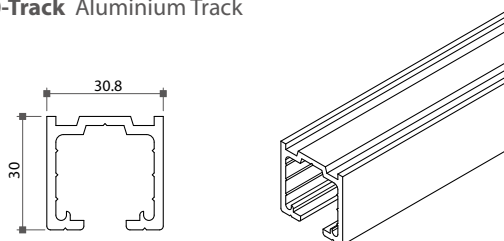

03-4 Interior Sliding Door

Mounting Instruction of 56950

Step 1 Measure and groove

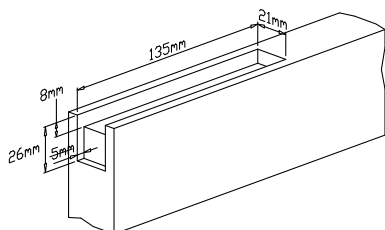

Step 2 Install the base

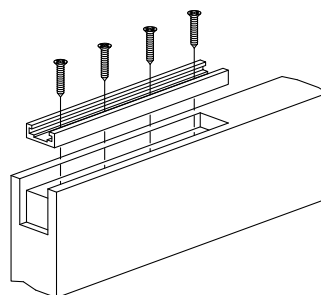

Step 3 Connect the gear and base

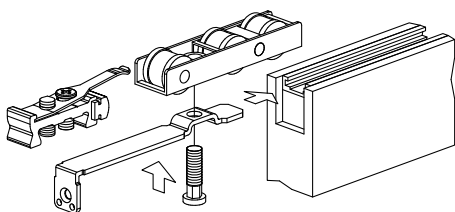

Step 4 Adjust height

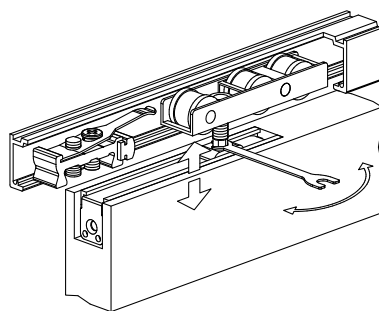

Step 5 Fasten the gear

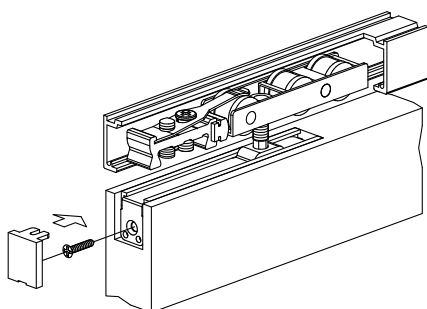

Step 6 Fix the end cap

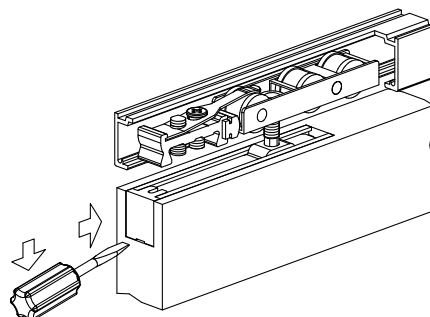

Step 7 Adjust the stopper

