

# 12-3 Medical & Industrial Castors

## MBSC Medical Bed Castor - single wheel

- \* Plastic housing of polyamide and glass fiber
- \* PP wheel with TPE tread
- \* Cover in PP
- \* Applicable to nursing beds and operation tables
- \* Multiple features seletions: total lock, free swivel or direction lock



	Dia.	W	Height	Dynamic Loading capacity
Item No.				
MBSC125	Ø125mm	32mm	171mm	120 kgs / per castor
MBSC150	Ø150mm	32mm	198.5mm	150 kgs / per castor
MBSC200	Ø200mm	35mm	240mm	150 kgs / per castor

\* Various top stems (For both MBSC and MBTC castors)

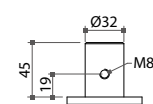
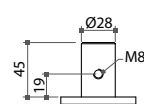
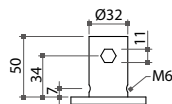
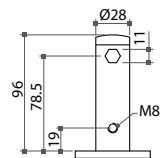
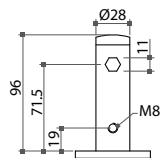

## MBTC Medical Bed Castor - Twin wheels

- \* Plastic housing of polyamide and glass fiber
- \* Polyamide wheel with TPE tread
- \* Cover in PP
- \* Applicable to nursing beds and operation tables
- \* Multiple features seletions: total lock, free swivel or direction lock



	Dia.	W	Height	Dynamic Loading capacity
Item No.				
MBTC125	Ø125mm	85mm	150mm	120 kgs / per castor
MBTC150	Ø150mm	85mm	175mm	150 kgs / per castor